

06_VERTICAL CASCADE GARDEN SPECIFICATION – LIGHTS, EXTERNAL CORNER

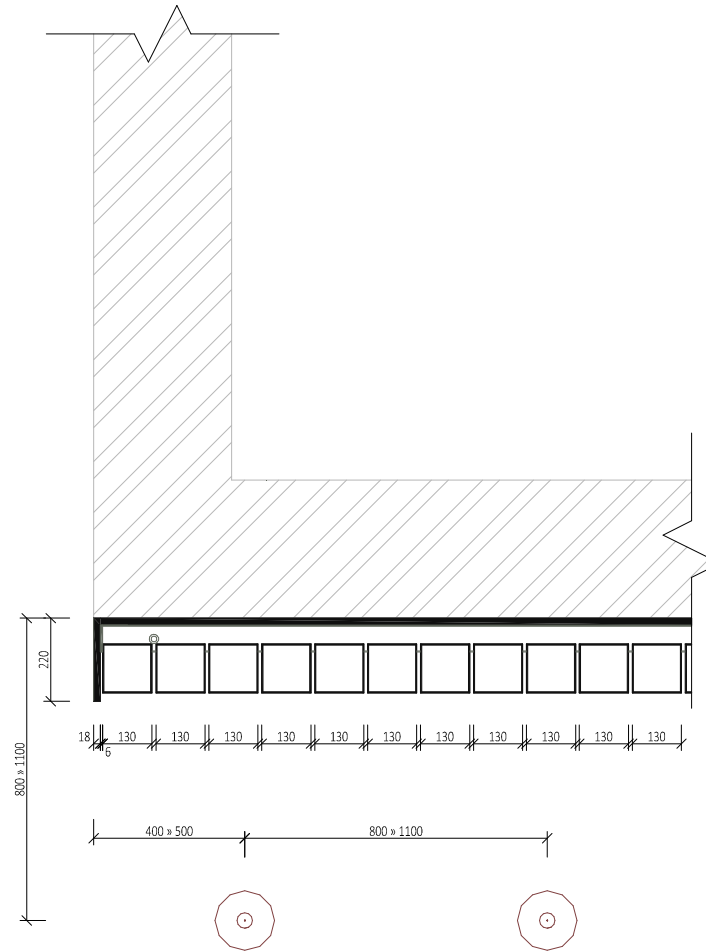
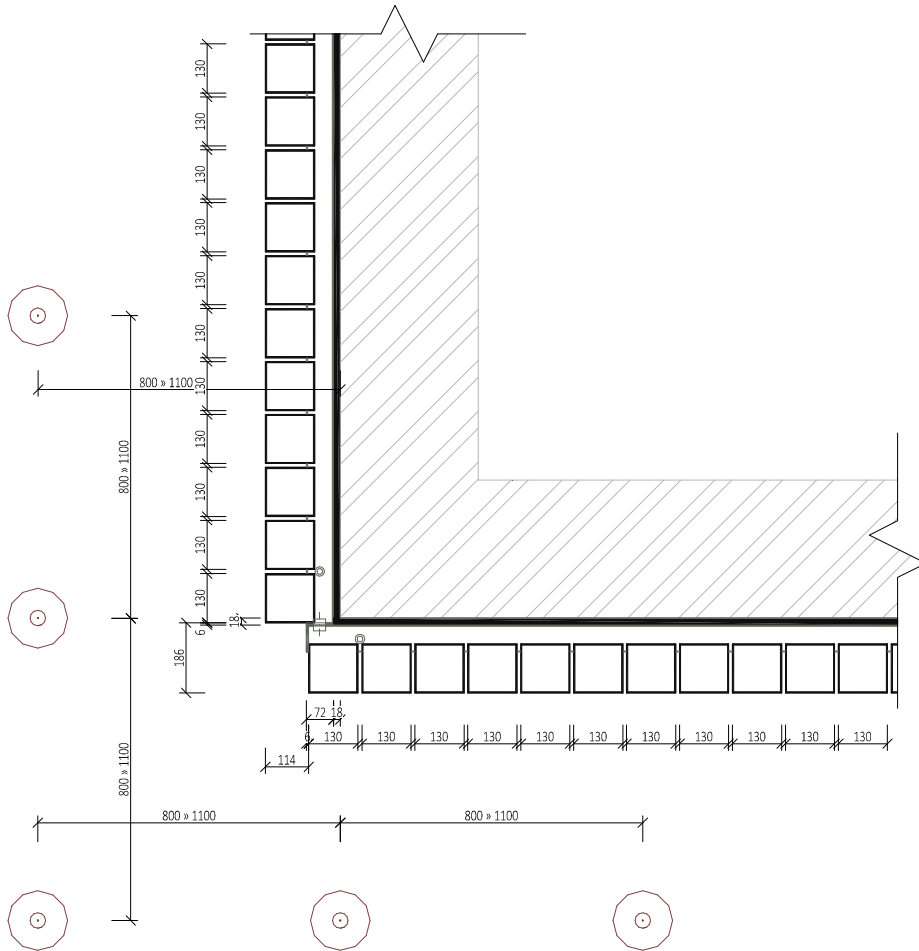

VERTICAL CASCADE GARDEN SHOULD BE INSTALLED ONTO 18MM OSB BOARDS.
 OSB BOARDS SHOULD BE ATTACHED TO THE SUBSTRATE WALL DIRECTLY OR USING A UA ALU PROFILE (BEARING LOAD OF AT LEAST 60KG/M²).
 TROUGHS ARE ATTACHED ONTO THE OSB BOARDS USING TX20 SCREWS 500MM APART AND 100MM FROM THE EDGE.
 VISIBLE SIDE AND BOTTOM EDGE DETAIL IS MADE FROM 18MM MDF / SDK 15MM (INTERNAL ONLY).

LIGHTING SPECIFICATION:
 LIGHT INTENSITY MIN.600 lx
 LIGHT TEMPERATURE (COLOUR) MIN. 4000 K